



## Product Specification

Central Diesel provides these specifications as a courtesy and are a guide only. They have been sourced from the manufacturer and may change without notice. Central Diesel accepts no responsibility for any errors or omissions.



**Sundyne***SUNFLO*  
High-Pressure  
Centrifugal Pumps

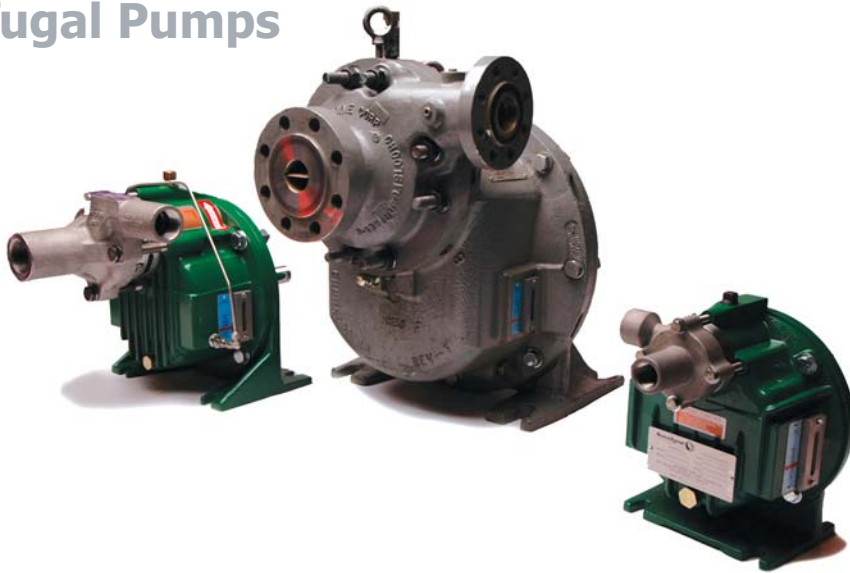

*Industrial Strength Solutions Made Easy™*

Sundyne Corporation designs, manufactures and supports industrial pump and compressor products for the process fluid and gas industries. With manufacturing facilities in the United States, England, France, Germany, and a joint venture in Japan, Sundyne is well positioned to solve the challenges facing its global customers. The company's products include high-speed centrifugal pumps, compressors, sealless pumps, sanitary pumps and other process engineered packaging.

Sundyne Corporation is a division of Hamilton Sundstrand, a United Technologies Corporation (UTC) subsidiary, and serves its customers in over 117 countries supported by a vastly experienced network of representatives and distributors — our channel partners.

We are here to stay --  
to keep you up  
and running!

# Reliable, High Pressure Performance

**P-1500**

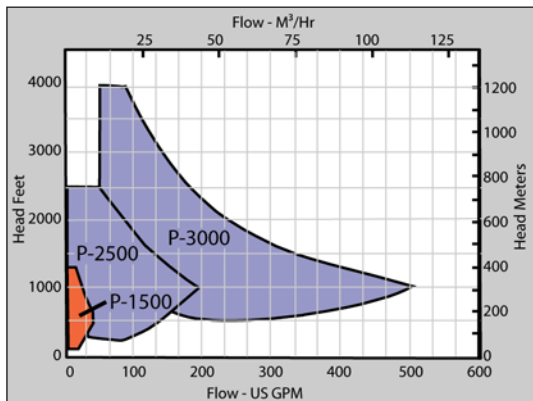

## Why Sundyne Sunflo?

**P-2500**

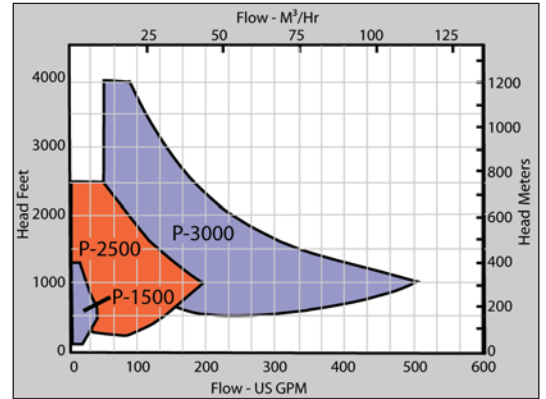

► Access **PRODUCT LAUNCH** at:  
[www.sundyne.com](http://www.sundyne.com)

## More Features Than Ever Before

Sundyne innovative engineering has developed a robust design to meet your rigorous application requirements. The results are field-proven and include:

- Unprecedented reliability
- 25,000 hr MTBR
- Ease of maintenance
- Interchangeable shaft assembly
- Prevention of lubrication contamination resulting in longer bearing life
- Multiple seal plans
- ...and more



*Sundyne's Application Success Defines Our Vision:*  
**...we ARE the world class leader in powering the  
production of life's basic needs.**

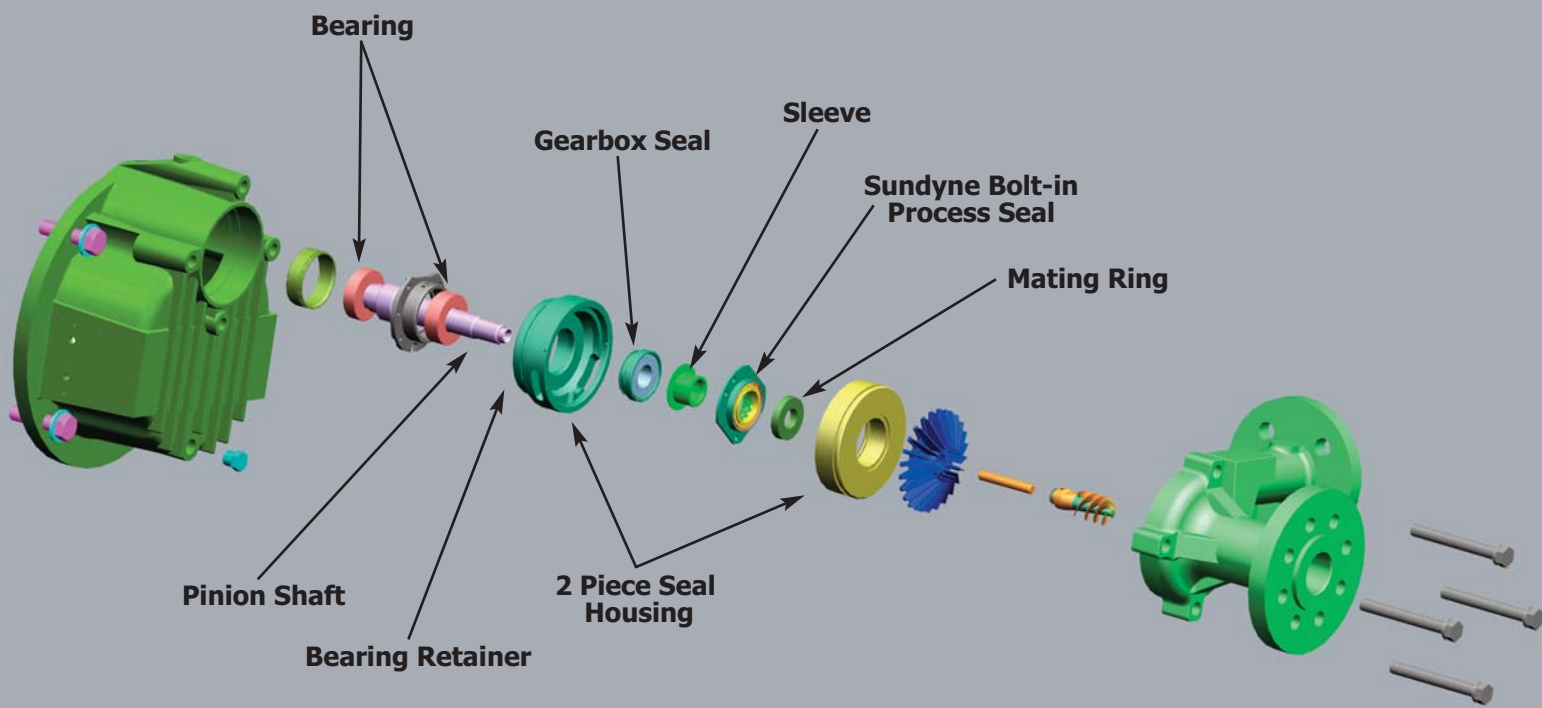

Pocket Folder

For a complete list of Sundyne Sunflo distributors worldwide, browse the PARTNER LOCATOR at: [www.sundyne.com](http://www.sundyne.com)

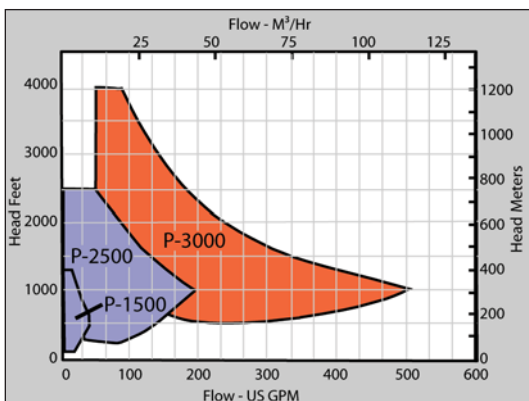

## P-3000



### Standard Materials of Construction (All Models)

Pump Casing	316 S.S.
Seal Housing	316 S.S.
Seal Parts	316 S.S.
Impeller/Inducer	316 S.S.
Shaft Sleeve	316 S.S.
Diffuser Plate	316 S.S.
Shaft	AISI 4140/8620/9310
Drive and Pinon Gear	AISI 4140/8620/9310
Gearbox Housing/Mounting Frame	Aluminum or Cast Steel

*\*Special alloys available upon request.*

- ▶ **Pollution Control**
- ▶ **Chemical and Petroleum**
- ▶ **Power Systems**

- ▶ **General Industrial**
- ▶ **Pulp and Paper**
- ▶ **Vehicle Manufacturing**

- ▶ **Mining**
- ▶ **Food and Beverage**
- ▶ **Oil production**



### Retrofit Your Sunflo HSSA TODAY!

Convert your P-2000 to a P-2500 and take advantage of the many feature enhancements now available -- at a fraction of the cost of a new pump. Realize significant gains in performance, reliability and longer life.

Sundyne Sunflo offers a factory exchange program for its high-speed shaft assembly replacements. This convenient program allows you to send in your old shaft assembly and receive a return credit, providing significant cost savings. Best of all, rebuilt units have the same quality construction, testing and factory warranty as new shaft assemblies.

The shaft assembly comes complete with all the rotating parts, seals and bearings making an in-place overhaul fast and trouble-free. Sundyne remains committed to making it easier for you to do business with us. Visit [www.sundyne.com](http://www.sundyne.com) for more detail.

## Solving Your High-Pressure Pumping Challenges

The Sundyne Sunflo series of pumps represents a legacy of innovative engineering excellence. Compare the complete Sunflo family series below for the configuration that best meets your needs:



	P-1500	P-2500	P-3000
<b>Model</b>	P-1500	P-2500	P-3000
<b>Flow To</b>	33 gpm (7.5 m <sup>3</sup> /hr)	180 (41 m <sup>3</sup> /hr)	500 gpm (114 m <sup>3</sup> /hr)
<b>Heads To</b>	1300 ft (396 m)	2,600 (792 m)	4200 ft (1280 m)
<b>Max Power</b>	10 hp (7 kw)	75 hp (55 kw)	250 hp (186 kw)
<b>Temp Range</b>	-50 to 300°F (-46 to 149°C)	-50 to 300°F (-46 to 149°C)	-50 to 350°F (-46 to 177°C)
<b>Number of Stages</b>	1	1	1
<b>Max Case Working Pressure</b>	1,000 psi (70 kg/cm <sup>2</sup> )	1,440 psi (105 kg/cm <sup>2</sup> )	2,160 psi (152 kg/cm <sup>2</sup> )
<b>Max Suction Pressure</b>	125/200 psi (9/14 kg/cm <sup>2</sup> )	250 psi (18 kg/cm <sup>2</sup> )	350 psi (25 kg/cm <sup>2</sup> )
<b>Speed Range</b>	13,000 - 32,000 rpm	5,987 - 14,707 rpm	6,756 - 17,750 rpm
<b>Bearing Materials Available</b>	Rolling Element, Oil Lubricated, Grease Packed	Rolling Element, Oil Lubricated, Grease Packed	Rolling Element, Journal Bearings Oil Lubricated, Grease Packed
<b>Hydro Test Pressure</b>	1,080 psig (76 kg/cm <sup>2</sup> )	2,160 psig (152 kg/cm <sup>2</sup> )	2,160 psig (152 kg/cm <sup>2</sup> )
<b>Max Viscosity</b>	Consult Factory	Consult Factory	Consult Factory

**Typical Applications** Boiler Feed, Reverse Osmosis, NOx Suppression, Washdown, Injection, Seal Flush, Condensate Return, Gun Drilling, Felt Shower, Trim Squirt, Plane De-icing, Mining Dust Suppression

<b>Industries</b>	Chemicals & Petroleum Refining, Power Generation, Pulp & Paper, Food & Beverage, Water Treatment, General Industry, Mining, Automotive	Chemicals & Petroleum Refining, Power Generation, Pulp & Paper, Food & Beverage, Water Treatment, General Industry, Mining, Automotive	Chemicals & Petroleum Refining, Power Generation, Pulp & Paper, Food & Beverage, Water Treatment, General Industry, Mining, Automotive
<b>Solids Range</b>	up to 1000 microns	up to 1000 microns	up to 1000 microns
<b>Mounting Configurations</b>	Horizontal Right and Left, Vertical Up and Down (viewed from suction)	Horizontal Right and Left, Vertical Up and Down (viewed from suction)	Horizontal Right, Vertical Up (viewed from suction)
<b># Available Hydraulics</b>	36	147	244
<b>Seal Configurations Available</b>	Single, Double	Single, Double	Single, Double
<b>Available Inducer</b>	Yes	Yes	Yes
<b>Seal Plans for Sunflo Pumps</b>	11, 13, 21, 31, 41, 52, 53	11, 13, 14, 21, 23, 31, 32, 41, 52, 53, 54, 62	11, 13, 21, 31, 41, 52, 53
<b>Available Flanges</b>	300# RF	300# RF, 600# RF	900# RF, P-3 Discharge
<b>Pump Case Corrosion Allowance</b>	Generous Clearances, No Performance Degradation	Generous Clearance, No Performance Degradation	1/8" (3.2 mm)
<b>Suction and Discharge Size</b>	1" X 1"	2" X 1.5"	4" X 3", 3" X 2"

### SUNFLO Ease of Maintenance

The Sundyne "one person, one wrench, one hour" philosophy continues to be the cornerstone of the Sunflo family.

**Elapsed Time: (0:30 min)**





**HEAVY DUTY API PUMPS**

**HIGH PRESSURE PUMPS**

**SEALLESS PUMPS**

**SANITARY PUMPS**

**COMPRESSORS**

**SERVICE**

Dealer Label:

**Sundyne Corporation**  
14845 West 64th Avenue  
Arvada, Colorado 80007  
USA

Phone: 1.303.425.0800  
Fax: 1.303.425.0896  
[www.sundyne.com](http://www.sundyne.com)

© 2007 Sundyne Corporation  
All Rights Reserved  
01.0807A FRD/7000